

MAIN FLOOR
1696 SQ. FT.
9' CEILING HEIGHT

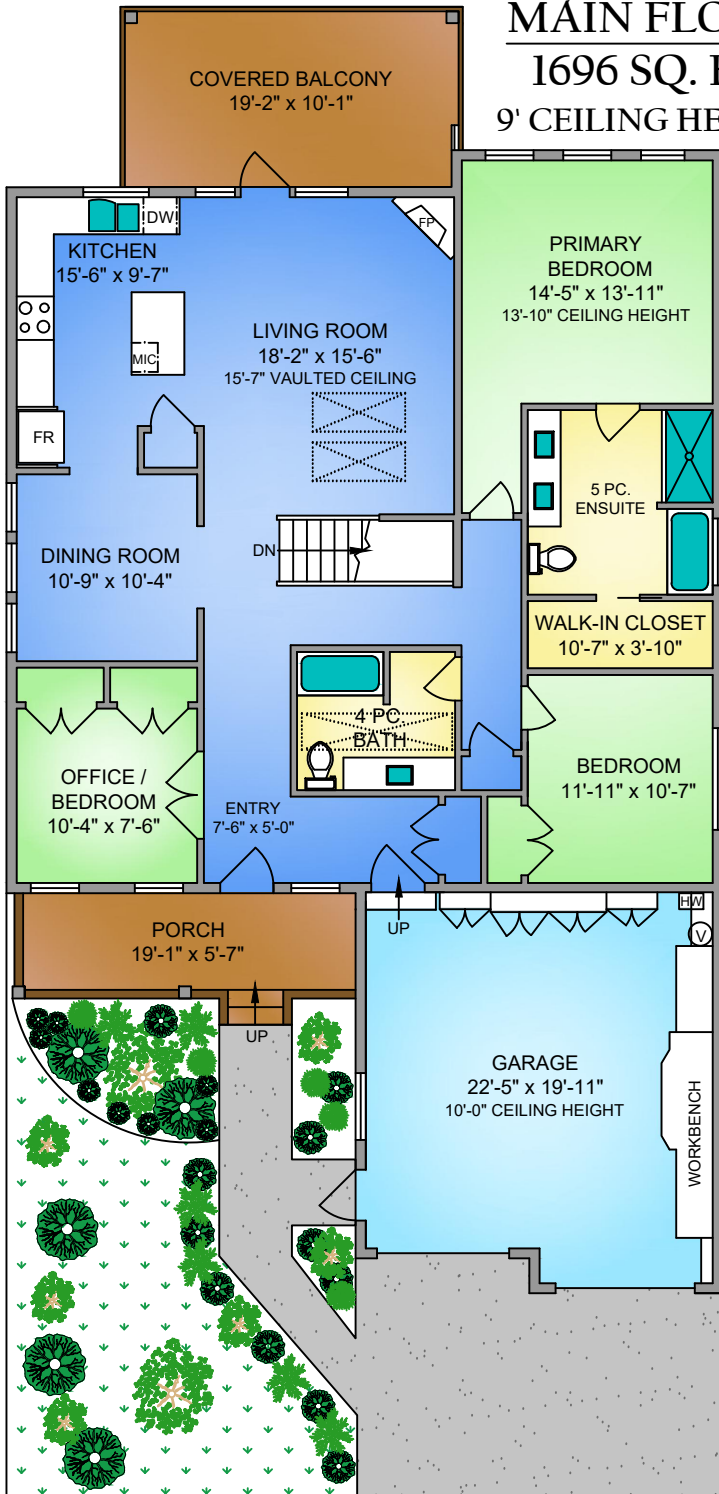

LOWER FLOOR
1344 SQ. FT.
8' CEILING HEIGHT



JOHN VERNON
 PERSONAL REAL ESTATE CORPORATION
& ASSOCIATES
 WEST COAST INSPIRED

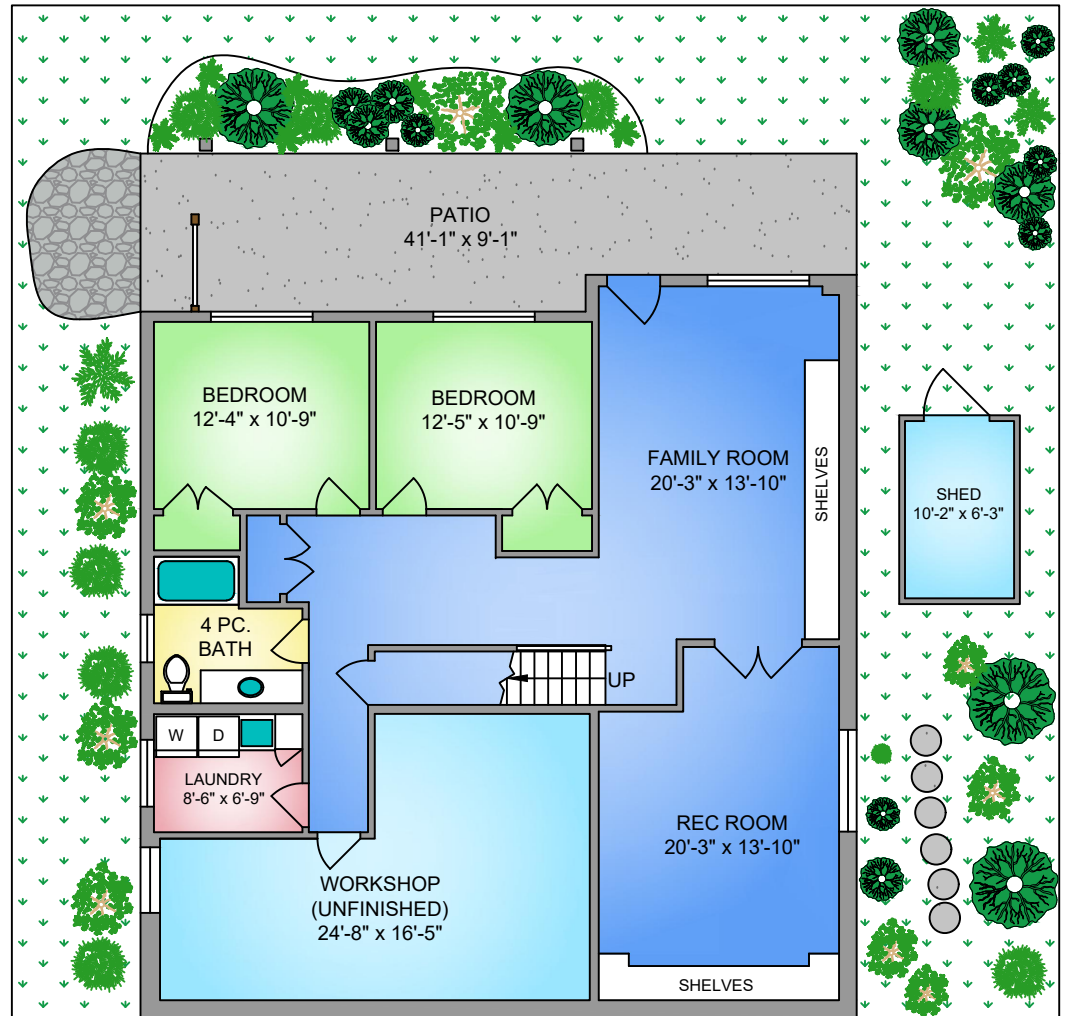

NORTH

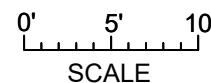

PROPERMEASURE
 FROM PRECISION TO PERFECTION
 propermeasure.com | 250.884.9753
 matt@propermeasure.com

2257 MAPLE AVENUE NORTH AUGUST 16, 2021 PREPARED FOR THE EXCLUSIVE USE OF JOHN VERNON PLANS MAY NOT BE 100% ACCURATE. IF CRITICAL BUYER TO VERIFY.				
FLOOR	AREA (SQ. FT.)			
	FINISHED	UNFINISHED	GARAGE	BALCONY / PATIO / PORCH
MAIN	1696	-	465	298
LOWER	1344	353	-	340
TOTAL	3040	353	465	638